



1



2



3

RP810 > A-B DESCENDER. COLOUR OPTIONS AVAILABLE.

ISC MANUFACTURES AN EXTENSIVE RANGE OF ASCENDERS AND DESCENDERS FOR USE ON A WIDE VARIETY OF ROPES. ALL ASCENDERS AND DESCENDERS CONFORM TO RELEVANT EUROPEAN AND ANSI STANDARDS.

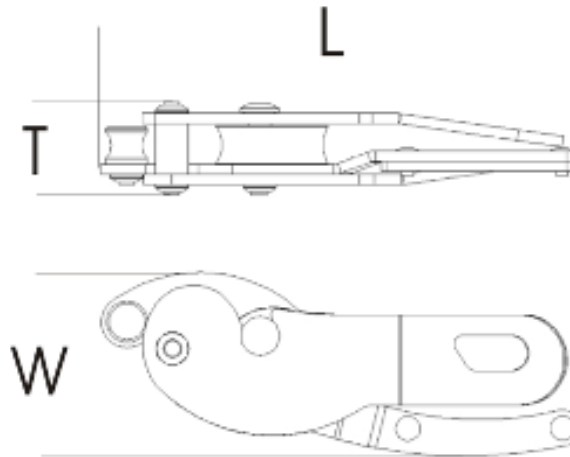

DIMENSIONS >
LENGTH > 200MM
WIDTH > 79MM
THICKNESS > 35MM

FEATURES > SUITABLE FOR 2 MAN LOAD, DOUBLE ACTION ANTI PANIC HANDLE.
MATERIAL > ALUMINIUM ALLOY
APPROVED STANDARDS > PR EN12841'C
FINISH > ANODISED
QUALITY > 100% INSPECTED & FUNCTION TESTED
WEIGHT > 436 G