

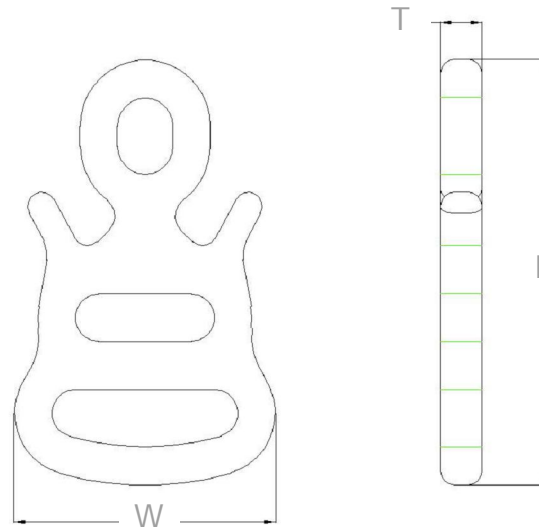

RP120> MINI FIGURE 8.

ISC MANUFACTURES AN EXTENSIVE RANGE OF ASCENDERS AND DESCENDERS FOR USE ON A WIDE VARIETY OF ROPES. ALL ASCENDERS AND DESCENDERS CONFORM TO RELEVANT EUROPEAN AND ANSI STANDARDS.



**DIMENSIONS >**  
**LENGTH >** 89MM  
**WIDTH >** 56MM  
**THICKNESS >** 9MM

**MATERIAL >** ALUMINIUM  
**MINIMUM BREAKING STRENGTH >** 25KN  
**ROPE DIAMETER >** 5-6MM  
**APPROVED STANDARDS >** NFPA APPROVED  
**FINISH >** ANODISED  
**QUALITY >** 100% INSPECTED AND PROOF LOADED  
**WEIGHT >** 56G

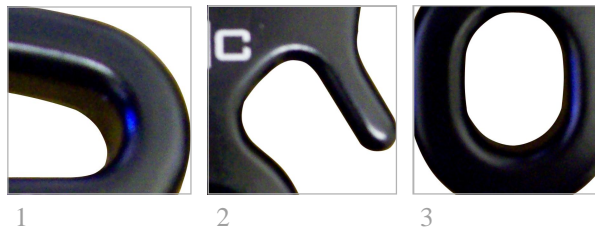

International Safety Components Ltd  
 Unit 1, Llanygai Industrial Estate,  
 Bangor  
 Gwynedd  
 LL57 4YH  
 United Kingdom  
**T-** +44 (0) 1248 363 110  
**F-** +44 (0) 1248 372 348  
**E-** sales@iscwales.com  
**W-** www.iscwales.com