

# PULLEYS > ALUMINIUM >

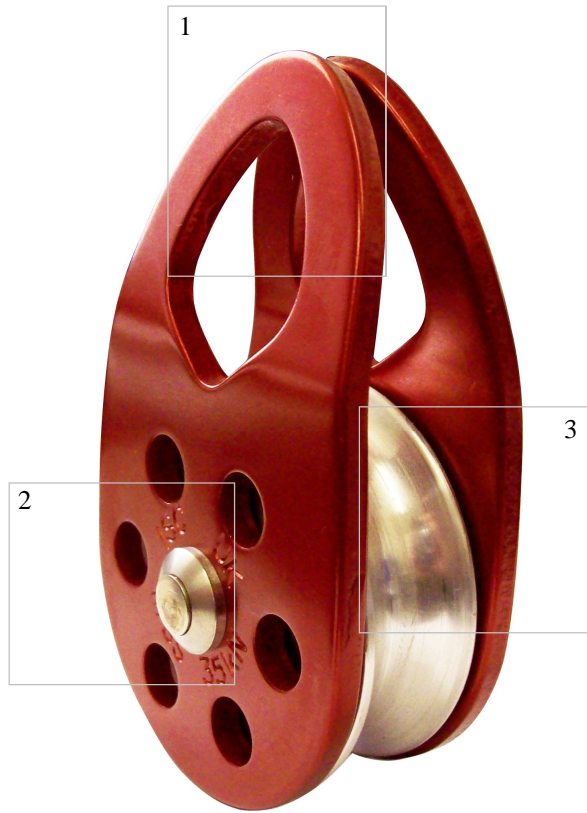

**RP032** > MEDIUM SINGLE EIGER, SINGLE ENDED COLOUR OPTIONS AVAILABLE.

ISC MANUFACTURES AN EXTENSIVE RANGE OF ALUMINIUM PULLEYS. FOR USE ON 10 MM - 16 MM ROPE. ALL ALUMINIUM PULLEYS CONFORM TO RELEVANT EUROPEAN AND ANSI STANDARDS.

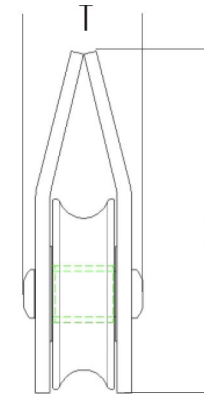
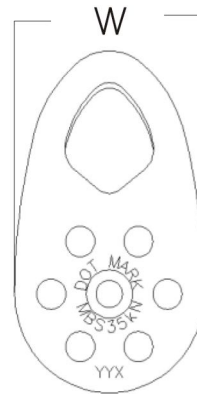

**DIMENSIONS** >  
**LENGTH** > 89mm  
**WIDTH** > 52mm  
**THICKNESS** > 33mm

**MATERIAL** > HIGH STRENGTH ALUMINIUM ALLOY  
**ROPE SIZE** > 10—13 MM  
**MINIMUM BREAKING STRENGTH** > 35kn  
**APPROVED STANDARDS** > BS EN 12278  
**FINISH** > ANODISED  
**QUALITY** > 100% INSPECTED  
**WEIGHT** > 158g



1

2

3