

PULLEYS > ALUMINIUM >

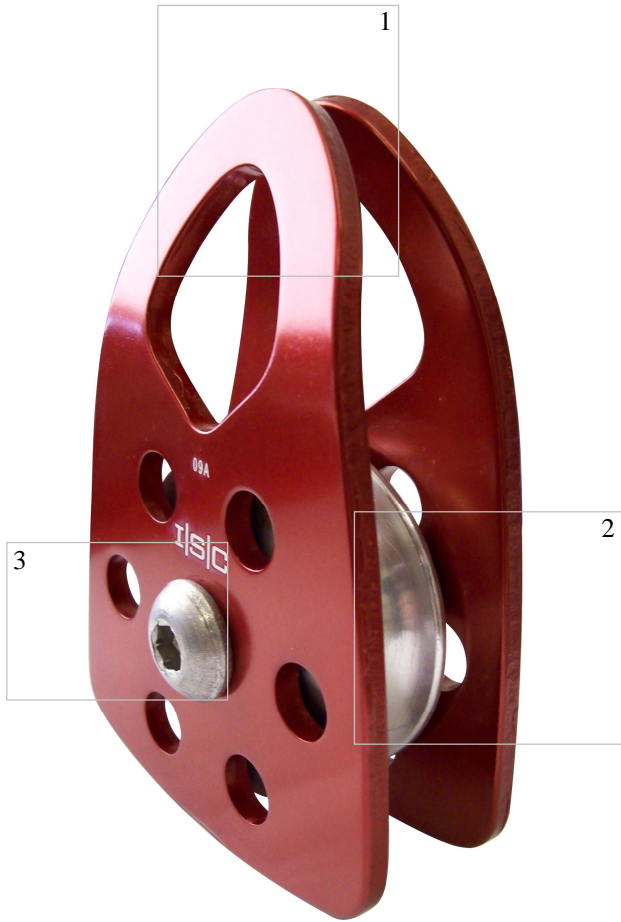

RPO21A > SMALL ALUMINIUM PRUSSIK.
COLOUR OPTIONS AVAILABLE.

ISC MANUFACTURES AN EXTENSIVE RANGE OF ALUMINIUM PULLEYS. FOR USE ON 10 MM - 16 MM ROPE. ALL ALUMINIUM PULLEYS CONFORM TO RELEVANT EUROPEAN AND ANSI STANDARDS.

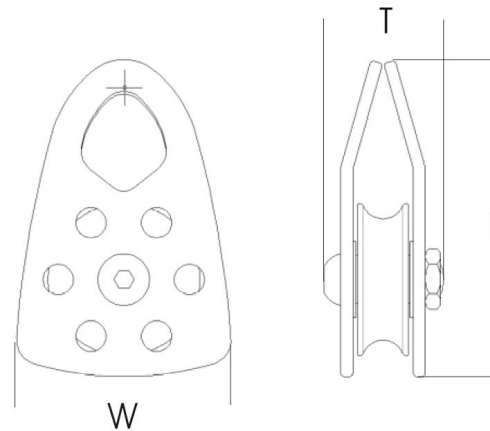

DIMENSIONS >
LENGTH > 104mm
WIDTH > 70mm
THICKNESS > 39mm

MATERIAL > HIGH STRENGTH ALUMINIUM ALLOY
ROPE SIZE > 13mm
MINIMUM BREAKING STRENGTH > 40kn
APPROVED STANDARDS > BS EN 12278
MEETS NFPA (1983) (G)
FINISH > ANODISED
QUALITY > 100% INSPECTED
WEIGHT > 220g



1

2

3

I|S|C
SOLUTIONS IN METAL

International Safety Components Ltd
Unit 1, Llandygai Industrial Estate,
Bangor
Gwynedd
LL57 4YH
United Kingdom
T- +44 (0) 1248 363 110
F- +44 (0) 1248 372 348
E- sales@iscwales.com
W- www.iscwal.es.com