

PULLEYS > ALUMINIUM >

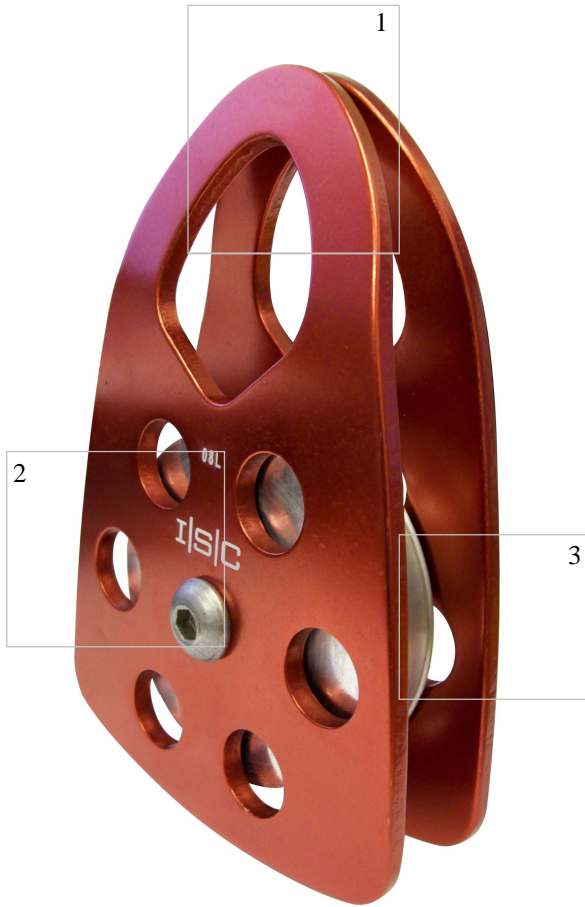

RP017A > SMALL EIGER SINGLE ENDED.
COLOUR OPTIONS AVAILABLE.

ISC MANUFACTURES AN EXTENSIVE RANGE OF ALUMINIUM PULLEYS. FOR USE ON 10 MM - 16 MM ROPE. ALL ALUMINIUM PULLEYS CONFORM TO RELEVANT EUROPEAN AND ANSI STANDARDS.

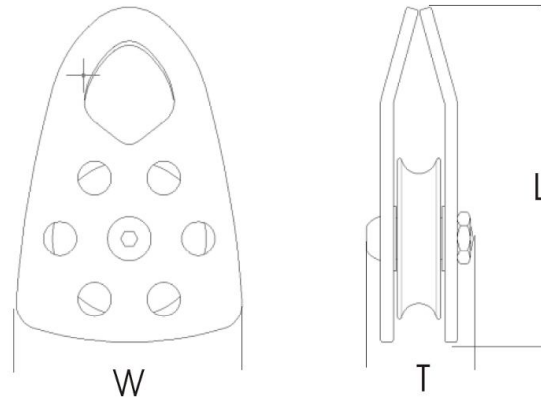

DIMENSIONS >
LENGTH > 130mm
WIDTH > 88mm
THICKNESS > 30mm

MATERIAL > HIGH STRENGTH ALUMINIUM ALLOY

ROPE SIZE > 13mm
MINIMUM BREAKING STRENGTH > 45kn
APPROVED STANDARDS > BS EN 12278
 MEETS NFPA (1983) (G)
FINISH > ANODISED
QUALITY > 100% INSPECTED
WEIGHT > 348g



1

2

3



International Safety Components Ltd
 Unit 1, Llandygai Industrial Estate,
 Bangor
 Gwynedd
 LL57 4YH
 United Kingdom
T- +44 (0) 1248 363 110
F- +44 (0) 1248 372 348
E- sales@iscwales.com
W- www.iscwales.com